

Charnley Retractors

Enabling a clear view and retraction of the hip capsule and musculature.

The Enztec Charnley Retractor systems are utilised during total hip athroplasty.

With two frame styles, both the spiked and clawed retractors are available in various lengths, providing a Charnley Retractor system to suit your needs.

- Standard Frame
- Fixed Blade (FB) Frame
- Spiked Retractors
- FB Spiked Retractors
- Clawed Retractors
- FB Clawed Retractors

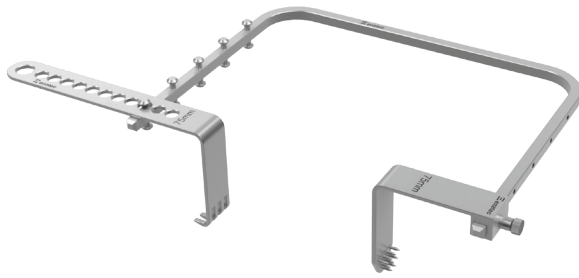

FB SPIKED
RETRACTORS



FB CLAWED
RETRACTORS

**ENZTEC CHARNLEY
FIXED BLADE FRAME AND RETRACTORS**

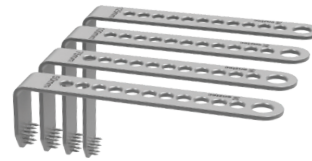
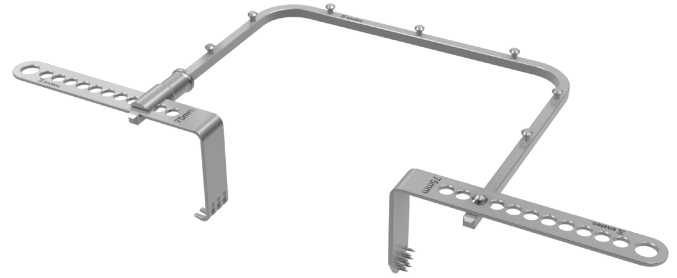

SPIKED
RETRACTORS

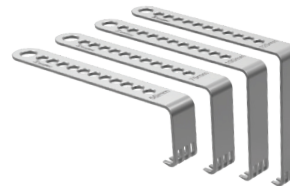

CLAWED
RETRACTORS

**ENZTEC CHARNLEY
STANDARD FRAME AND RETRACTORS**

Features

- Self-retaining frame and retractor system frees up surgical assistant
- Retractors available in spiked and clawed variants
- Multiple retractor lengths (50mm to 125mm) available to accommodate a wide range of patient anatomies
- Fixed Blade (FB) and standard retractors available

Specifications

- Materials: Stainless Steel
- Frame weight: 690g / 1.5lbs
- Frame dimensions: 256 x 200mm / 10.1 x 7.9in
- Retractor weight: 100-155g / 0.2-0.3lbs
- Retractor lengths: 50, 75, 100, 125mm / 2.0, 3.0, 3.9, 4.9in
- Add your logo: available